

THIS DRAWING IS UNPUBLISHED. RELEASED FOR PUBLICATION 20
 © COPYRIGHT 20 BY TYCO ELECTRONICS CORPORATION. ALL RIGHTS RESERVED.

LOC	DIST	REVISIONS			
P	LTR	DESCRIPTION	DATE	DWN	APVD
AJ	00	AI	REVISED PER ECO 07-016324	11JUL2007	DW KW

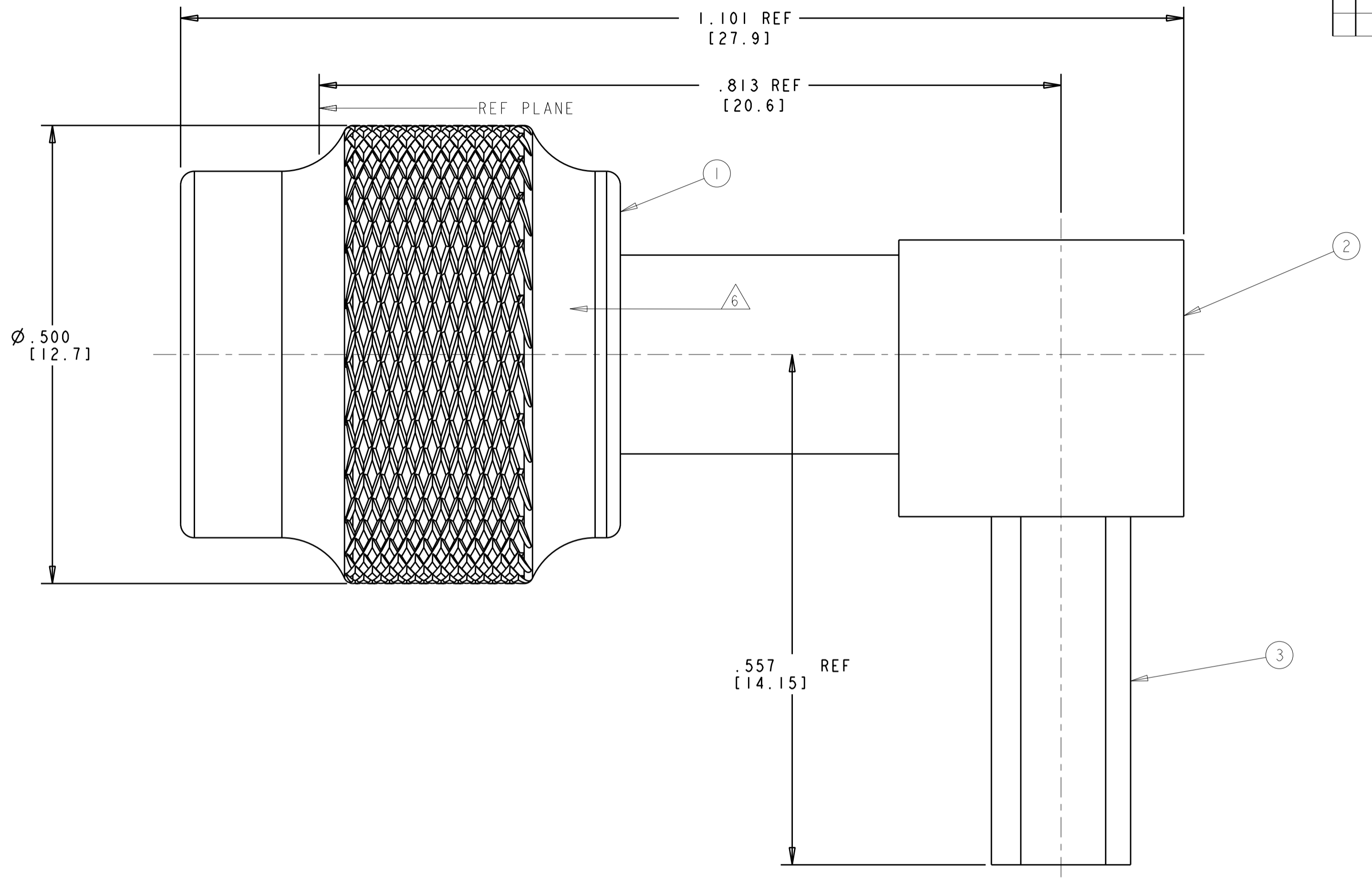

1. DESIGNED FOR USE WITH RG316 OR EQUIV CABLES.
 2. ITEMS PACKAGED UNASSEMBLED.
 3. SEE SEPERATE CUSTOMER DRAWINGS FOR ITEM DETAILS.
 4. SEE INSTRUCTION SHEET 408-10144 FOR CABLE TERMINATION DETAILS.
 5. SEE SHEET 2 FOR MATING SMA JACK REQUIRMENTS.
- △ 6 MATE AND LOCK CONNECTOR BY SLIDING SLEEVE IN DIRECTION INDICATED.

1403102-5	1403081-5	1274695-1	1274694-1
③ FERRULE	② END CAP	① PLUG ASSY	PART NUMBER

<small>THIS DRAWING IS A CONTROLLED DOCUMENT FOR TYCO ELECTRONICS CORPORATION. IT IS SUBJECT TO CHANGE AND THE CONTROLLING ENGINEERING ORGANIZATION SHOULD BE CONTACTED FOR THE LATEST REVISION.</small>		DWN: D. WALLACE 01MAY2007 CHK: K. WEIDNER 01MAY2007 APVD: K. WEIDNER 01MAY2007	Tyco Electronics Harrisburg, PA 17105-3608
DIMENSIONS: INCHES	TOLERANCES UNLESS OTHERWISE SPECIFIED: 0 PLC ±: 1 PLC ±: 2 PLC ±: 3 PLC ±.010 [.254] 4 PLC ±: ANGLES ±: FINISH	PRODUCT SPEC: 108-2268 APPLICATION SPEC: - WEIGHT: -	NAME: SMA LOCKING PUSH-ON CABLE PLUG KIT SIZE: A200779 CAGE CODE: C-1274694 DRAWING NO: 1274694 RESTRICTED TO: -
MATERIAL: -		CUSTOMER DRAWING	
AMP 1471-9 REV 31MAR2000		SCALE: 10:1	SHEET 1 OF 2 REV AI

4

3

2

1

THIS DRAWING IS UNPUBLISHED. RELEASED FOR PUBLICATION 20
 © COPYRIGHT 20 BY TYCO ELECTRONICS CORPORATION. ALL RIGHTS RESERVED.

LOC	DIST	REVISIONS					
		P	LTR	DESCRIPTION	DATE	DWN	APVD
AJ	00	-		SEE SHEET 1	-	-	-

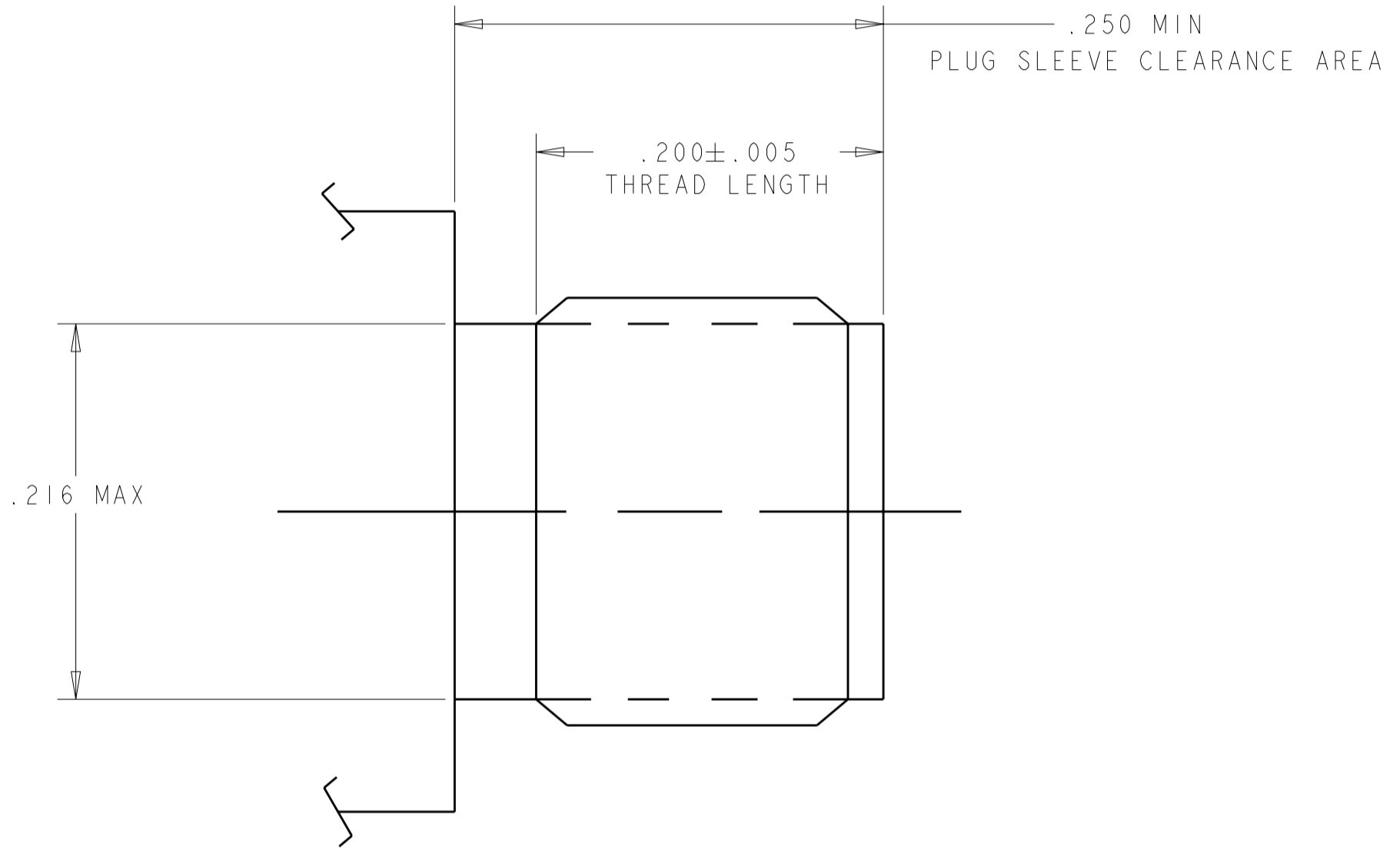

- 7. SMA JACKS MATED TO TYCO SMA LOCKING PLUGS SHALL MEET THE REQUIREMENTS INDICATED. ALL OTHER SMA JACK INTERFACE DIMENSIONS SHALL CONFORM TO MIL-STD-348
- 8. PRODUCT IS DESIGNED AND QUALIFIED TO MATE WITH GOLD PLATED SMA JACKS.

<small>THIS DRAWING IS A CONTROLLED DOCUMENT FOR TYCO ELECTRONICS CORPORATION. IT IS SUBJECT TO CHANGE AND THE CONTROLLING ENGINEERING ORGANIZATION SHOULD BE CONTACTED FOR THE LATEST REVISION.</small>		DWN D. WALLACE 01MAY2007 CHK K. WEIDNER 01MAY2007 APVD K. WEIDNER 01MAY2007	Tyco Electronics Tyco Electronics Harrisburg, PA 17105-3608
DIMENSIONS: INCHES 	TOLERANCES UNLESS OTHERWISE SPECIFIED: 0 PLC ±- 1 PLC ±- 2 PLC ±- 3 PLC ±.010 4 PLC ±- ANGLES ±1 FINISH	PRODUCT SPEC - APPLICATION SPEC - WEIGHT -	NAME SMA LOCKING CABLE PLUG, R/A SOLDER/CRIMP - SIZE A200779 CAGE CODE C-1274694 DRAWING NO - RESTRICTED TO -
MATERIAL		CUSTOMER DRAWING	
		SCALE 1:2	SHEET 2 OF 2 REV A1